



Professionelle Radial Compression Tools

| | | | | | |
|--|---|--|--|---|---|
|  LMTIPS (1) |  PS59/6/RGB (1) | |  CPLCCT-SLM (1) | | |
|  FS6U (5) |  FS6RCAU (5) |  FS6BNCU (5) |  FS59BNCU (5) |  FS59RCAU (5) |  FS59U (5) |
|  RG6RCAU (5) |  RG6BNCU (5) |  FSBNC1RGB (5) |  FSRCA1RGB (5) |  RG59BNCU (5) |  RG59RCAU (5) |
| INSTRUCTIONS SHEETS & CD CATALOG | |  RGBNC1RGB (5) |  RGBNC1RGB (5) | <ul style="list-style-type: none"> FSCR-W (5) FSCR-Y (5) FSCR-R (5) FSCR-G (5) FSCR-B (5) | |

PMD Compression Tools bieten Ihnen durch qualitativ hochwertige Anschlussvarianten die optimale Lösung zur Sicherstellung Ihrer Installationen. Das intuitive System erleichtert das Konfektionieren von Kabeln vor Ort und garantiert eine fehlerfreie Signalübertragung. Jeder Anschluss hält nach Beendigung der Kompressionsverfahrens einer Zuglast von über 40kg stand. Ersparen Sie sich die lästige Suche nach fehlerhaft gecrimpten Steckern und setzen auch Sie auf die sicherste Lösung die der Weltmarkt zur Zeit zu bieten hat.



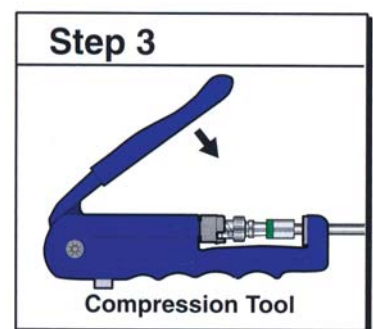
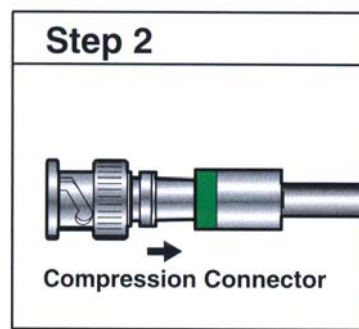
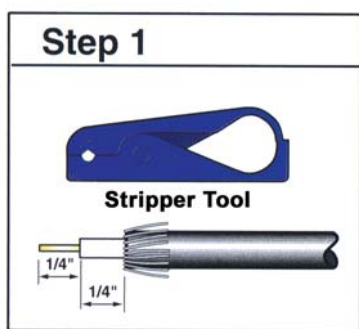

| Bezeichnung | Beschreibung | Art.-Nr. |
|-------------|--------------|----------|
|-------------|--------------|----------|

■ Mini Coax Kabel 24-26AWG

| | | |
|------------|---|--------------|
| FS BNC1RGB | BNC Compression-Connector/Stecker für Mini Koaxial Kabel, 24-26AWG, orange, 5-er Pack | 8627-0001-01 |
| FS RCA1RGB | RCA Compression-Connector/Stecker für Mini Koaxial Kabel, 24-26AWG, orange, 5-er Pack | 8627-0004-01 |
| RG BNC1RGB | BNC Compression-Connector/Stecker für Mini Koaxial Kabel, 24-26AWG, orange, 5-er Pack, gold | 8627-0009-01 |
| RG RCA1RGB | RCA Compression-Connector/Stecker für Mini Koaxial Kabel, 24-26AWG, orange, 5-er Pack, gold | 8627-0010-01 |

■ Mini Coax Kabel 22-24 AWG

| | | |
|-------------|--|--------------|
| FS BNC15RGB | BNC Compression-Connector/Stecker für Mini Koaxial Kabel 22-24AWG, lila, 5-er Pack | 8627-0003-01 |
| FS RCA15RGB | RCA Compression-Connector/Stecker für Mini Koaxial Kabel 22-24AWG, lila, 5-er Pack | 8627-0004-01 |
| RG BNC15RGB | BNC Compression-Connector/Stecker für Mini Koaxial Kabel 22-24AWG, lila, 5-er Pack, gold | 8627-0011-01 |
| RG RCA15RGB | RCA Compression-Connector/Stecker für Mini Koaxial Kabel 22-24AWG, lila, 5-er Pack, gold | 8627-0012-01 |

■ RG 59 Kabel

| | | |
|-----------|---|--------------|
| FS59 BNCU | BNC Compression-Connector/Stecker für RG59 Kabel, 20AWG, rot, 5-er Pack | 8627-0005-01 |
| FS59 RCAU | RCA Compression-Connector/Stecker für RG59 Kabel, 20AWG, rot, 5-er Pack | 8627-0006-01 |
| RG59 BNCU | BNC Compression-Connector/Stecker für RG59 Kabel, 20AWG, rot, 5-er Pack, gold | 8627-0013-01 |
| FS 59U | F-Compression-Connector/Stecker für RG59 Kabel, 20AWG, rot, 5-er Pack | 8627-0020-01 |
| RG 59U | F-Compression-Connector/Stecker für RG59 Kabel, 20AWG, rot, 5-er Pack, gold | 8627-0022-01 |

■ RG 6 Kabel

| | | |
|----------|---|--------------|
| FS6 BNCU | BNC Compression-Connector/Stecker für RG6 Kabel, 18AWG, grün, 5-er Pack | 8627-0007-01 |
| FS6 RCAU | RCA Compression-Connector/Stecker für RG6 Kabel, 18AWG, grün, 5-er Pack | 8627-0008-01 |
| RG6 BNCU | BNC Compression-Connector/Stecker für RG6 Kabel, 18AWG, grün, 5-er Pack, gold | 8627-0015-01 |
| RG6 RCAU | RCA Compression-Connector/Stecker für RG6 Kabel, 18AWG, grün, 5-er Pack, gold | 8627-0016-01 |
| FS6U | F-Compression-Connector/Stecker für RG6 Kabel, 18AWG, grün, 5-er Pack | 8627-0021-01 |
| RG6U | F-Compression-Connector/Stecker für RG6 Kabel, 18AWG, grün, 5-er Pack, gold | 8627-0023-01 |





F-Conn Connector Sizing Chart (mm)

| | | | BASIC | DB | COMMERCIAL | GOLD | COMMERCIAL Splice/Insert | GOLD Splice/Insert |
|--|------------------|--------------|---|---|---|---|---|---|
| RG1 (24-26 AWG*) ORANGE | MIN ~ MAX | | | | | | | |
| | Center Conductor | .38 ~ .64 | | | FSRCA1RGB FSBNC1RGB FS1RCA FS1BNC | RGRCA1RGB RGBNC1RGB RG1RCA RG1BNC | FS1RCASST FS1BNCSSST | RG1RCASST RG1BNCSSST |
| | Dielectric | 1.65 ~ 1.98 | | | | | | |
| | Outer Jacket | 2.41 ~ 2.79 | | | | | | |
| RG15 (22-24 AWG*) PURPLE | MIN ~ MAX | | | | | | | |
| | Center Conductor | .38 ~ .64 | | | FSRCA15RGB FSBNC15RGB FS15RCA FS15BNC | RGRCA15RGB RGBNC15RGB RG15RCA RG15BNC | FS15RCASST FS15BNCSSST | RG15RCASST RG15BNCSSST |
| | Dielectric | 2.41 ~ 2.67 | | | | | | |
| | Outer Jacket | 3.68 ~ 4.06 | | | | | | |
| * This AWG is a reference point only please make sure you spec the cable to ensure proper fit. | | | | | | | | |
| RG59 PLENUM RED | MIN ~ MAX | | | | FS59PL FS59BNCPL FS59RCAPL | | | |
| | Center Conductor | .81 ~ .86 | | | | | | |
| | Dielectric | 3.73 ~ 3.99 | | | | | | |
| | Outer Jacket | 4.83 ~ 5.59 | | | | | | |
| RG59 PLENUM 2 RED | MIN ~ MAX | | | DB59PL2/4 DB59BNCPL2/4 DB59RCAPL2/4 | FS59PL2 FS59BNCPL2 FS59RCAPL2 | | | |
| | Center Conductor | .81 ~ .86 | | | | | | |
| | Dielectric | 3.30 ~ 3.48 | | | | | | |
| | Outer Jacket | 4.83 ~ 5.59 | | | | | | |
| RG59 PLENUM 3 RED | MIN ~ MAX | | | DB59PL2 DB59BNCPL3 DB59RCAPL3 | FS59PL2 FS59BNCPL3 FS59RCAPL3 | | | |
| | Center Conductor | .53 ~ .61 | | | | | | |
| | Dielectric | 3.30 ~ 3.48 | | | | | | |
| | Outer Jacket | 4.83 ~ 5.59 | | | | | | |
| RG59 PLENUM 4 RED | MIN ~ MAX | | | DB59PL2/4 DB59BNCPL2/4 DB59RCAPL2/4 | FS59PL4 FS59BNCPL4 FS59RCAPL4 | | | |
| | Center Conductor | .81 ~ .86 | | | | | | |
| | Dielectric | 3.40 ~ 3.58 | | | | | | |
| | Outer Jacket | 4.83 ~ 5.59 | | | | | | |
| RG59 SECURITY RED | MIN ~ MAX | | | DB59BNCPL DB59RCASL | FS59BNCPL FS59RCASL | | | |
| | Center Conductor | .81 ~ .86 | | | | | | |
| | Dielectric | 3.48 ~ 3.76 | | | | | | |
| | Outer Jacket | 5.89 ~ 6.30 | | | | | | |
| RG59 STANDARD RED | MIN ~ MAX | | RG59WR RG59WRO RG59-RCAWR F59WRK | | | | | |
| | Center Conductor | .81 ~ .86 | | | | | | |
| | Dielectric | 3.66 ~ 3.99 | | | | | | |
| | Outer Jacket | 5.89 ~ 6.40 | | | | | | |
| RG59 Quad RED | MIN ~ MAX | | RG59NR | | | | | |
| | Center Conductor | .81 ~ .86 | | | | | | |
| | Dielectric | 3.66 ~ 3.99 | | | | | | |
| | Outer Jacket | 6.53 ~ 6.93 | | | | | | |
| RG59 UNIVERSAL RED | MIN ~ MAX | | | DB59U DB59BNCU | FS59U FS59URA FS59BNCU FS59RCAU FS59RCU FSBNC59URA FSRCA59URA FS59IECUM FS59IECUF | RG59U RG59BNCU RG59RCAU RG59IECUM RG59IECUF | FS59US FS59BNCUS FS59RCOUS FS59RCUUS FS59BNCUF FS59RCUUF | RG59US RG59BNCUS RG59RCOUS RG59RCUUS RG59BNCUF RG59RCUUF |
| | Center Conductor | .81 ~ .86 | | | | | | |
| | Dielectric | 3.66 ~ 3.99 | | | | | | |
| | Outer Jacket | 5.89 ~ 6.93 | | | | | | |
| RG6PL GREEN | MIN ~ MAX | | | | FS6PL FS6BNCPL FS6RCAPL | | | |
| | Center Conductor | 1.01 ~ 1.06 | | | | | | |
| | Dielectric | 4.65 ~ 4.90 | | | | | | |
| | Outer Jacket | 5.59 ~ 6.35 | | | | | | |
| RG6PL2 GREEN | MIN ~ MAX | | | DB6PL2 DB6BNCPL2 DB6RCAPL2 | FS6PL2 FS6BNCPL2 FS6RCAPL2 | | | |
| | Center Conductor | 1.01 ~ 1.06 | | | | | | |
| | Dielectric | 4.19 ~ 4.37 | | | | | | |
| | Outer Jacket | 5.59 ~ 6.35 | | | | | | |
| RG6 GREEN | MIN ~ MAX | | RG6WR RG6WRO RG6-RCAWR RG6WRK EF6WR F6SP | | | | | |
| | Center Conductor | 1.01 ~ 1.06 | | | | | | |
| | Dielectric | 4.57 ~ 4.90 | | | | | | |
| | Outer Jacket | 6.73 ~ 7.26 | | | | | | |
| RG6 Quad GREEN | MIN ~ MAX | | RG6NR RG6NRO | | | | | |
| | Center Conductor | 1.01 ~ 1.06 | | | | | | |
| | Dielectric | 4.57 ~ 4.90 | | | | | | |
| | Outer Jacket | 7.34 ~ 7.75 | | | | | | |
| RG6 UNIVERSAL GREEN | MIN ~ MAX | | | DB6U DB6BNCU | FS6U FS6URA FS6BNCU FS6RCAU FS6IECUM FS6IECUF FSBNC6URA FSRCA6URA | RG6U RG6BNCU RG6RCAU RG6IECUM RG6IECUF | FS6US FS6BNCUS FS6RCOUS FS6BNCUF FS6RCUUF | RG6US RG6BNCUS RG6RCOUS RG6BNCUF RG6RCUUF |
| | Center Conductor | 1.01 ~ 1.06 | | | | | | |
| | Dielectric | 4.57 ~ 4.90 | | | | | | |
| | Outer Jacket | 6.73 ~ 7.75 | | | | | | |
| RG11 UNIVERSAL BLACK | MIN ~ MAX | | F11WR F11SP | | FS11V FS11BNC | | | |
| | Center Conductor | 1.61 ~ 1.64 | | | | | | |
| | Dielectric | 7.11 ~ 7.47 | | | | | | |
| | Outer Jacket | 9.91 ~ 10.59 | | | | | | |
| RG11 PLENUM GRAY | MIN ~ MAX | | | | FS11PL | | | |
| | Center Conductor | 1.61 ~ 1.64 | | | | | | |
| | Dielectric | 7.11 ~ 7.47 | | | | | | |
| | Outer Jacket | 8.61 ~ 9.02 | | | | | | |

| TOOL | BASIC | DB | COMMERCIAL | GOLD | COMMERCIAL Splice/Insert | GOLD Splice/Insert |
|---------------|-------|----------|------------|------|-----------------------------|-----------------------|
| CPLCCT-1 | | | F & RCA* | | | |
| CPLCCT-S59/11 | | | F & RCA | | | |
| CPLCCT-F11 | | | F** | | | |
| CPLCCT-11BNC | | | BNC** | | | |
| CPLCCT-SLM | | | ALL* | ALL* | ALL* | ALL* |
| RTC360 | ALL* | | | | | |
| CPLCRTC | ALL* | F & RCA* | | | | |
| CPLCRBC | ALL* | ALL* | | | | |

* This will **NOT** work with RG11 Cable
 ** This will **ONLY** work on RG11 Cable

Distributor / Vertriebs:



| Bezeichnung | Beschreibung | Art.-Nr. |
|-------------|--|--------------|
| CPLCRBC-B | Radial Bubble Compression Tool | 8627-0030-01 |
| CPLCCT-SLM | Linear Compression Tool für Compressions Anschlüsse, RG59/6/Mini Koaxial Kabel | 8627-0018-01 |
| PS59/6/RGB | Abisolierer für RG59/6/Mini Koaxial Kabel | 8627-0019-01 |



| Bezeichnung | Beschreibung | Art.-Nr. |
|--------------------------------|--|--------------|
| Linear Compression Starter Kit | Starter Kit enthält: verschiedene BNC, RCA u. F-Connectoren für RG59, RG6 und Mini Coax; Linear Compression Tool, Abisolierer für RG59/6/Mini Coax | 8627-0031-01 |

Enthält:

| | | | |
|--------------|-------------|-------------|----------------------------------|
| 5x FSBNC1RGB | 5x FS59BNCU | 5x FS6BNCU | 1x Linear Compression Tool |
| 5x FSRCA1RGB | 5x FS59RCAU | 5x FS6RCAU | 1x Cable Stripper 59/6/mini coax |
| | 5x FS59U | 5x RG59BNCU | |

| Bezeichnung | Beschreibung | Art.-Nr. |
|-------------------------------------|--|--------------|
| Double Bubble Connector Starter Kit | Double Bubble Starter Kit enthält: Compression Tool, Abisolierer, Fit Tool, Diverse Compressions Anschlüsse (F, RG59, RG6) | 8627-0017-01 |



Distributor / Vertrieb: